

Call for toll free reservations (800) 327-1128

## Holiday Inn Main Gate East



**Holiday Inn**

5711 W. Irlo Bronson Memorial Highway  
(West U.S. Highway 192)  
Kissimmee, FL 34746  
Phone: (407) 396-4222 Fax: (407) 594-5276  
[www.holidayinnmge.com](http://www.holidayinnmge.com)

**H**oliday Inn Main Gate East is a **Walt Disney World® Good Neighbor Hotel** in the Kissimmee / Orlando, Florida area that has your family vacation accommodations when visiting the **Walt Disney World® Theme Parks, Sea World, Universal Studios**, Central Florida, Orlando's business district or Downtown Kissimmee. Holiday Inn Main Gate East has interior corridor access for all guest room accommodations for your added convenience. Your Holiday Inn Main Gate East lodging includes complimentary scheduled shuttle service to the **Walt Disney World® Theme Parks** and the **Lake Buena Vista Shopping Outlet Stores**.



---

### Your Hotel Amenities



Holiday Inn Main Gate East offers free scheduled transportation to the **Walt Disney World® Theme Parks** and the **Lake Buena Vista Shopping Outlet Stores**. Hotel guest parking and high speed internet access are always complimentary at the Holiday Inn Main Gate East. The outdoor heated pool, hot tub, and kid's pool are just the things needed after a long day at the parks. Enjoy a cool drink from Chianti's poolside lounge. Looking for a quick bite? The Trattoria Café and food court offers a great variety for the entire family. Be sure to visit our game room and challenge your family to an air hockey game. Afterwards, you can relax in the kid's theater and watch your favorite cartoons and movies. If the kids are still full of energy be sure to visit the playground located outside.

---

### Guest Room Accommodations available for Gaylord Palms Convention Center Attendees at the Holiday Inn Main Gate East

Attending a meeting, convention, or tradeshow at the Gaylord Palms Convention Center in the Kissimmee / Orlando area? Try the Holiday Inn Main Gate East for reasonable hotel room rates. When the Gaylord Palms Convention Center guest room rates are just too expensive or they are sold out, the Holiday Inn Main Gate East can accommodate you, just 0.7 miles from the Gaylord Palms Convention Center.

---

### Conveniently located minutes from Orlando International Airport - (MCO)

The Holiday Inn Main Gate East is conveniently located 20 miles from the Orlando International Airport (code: MCO). The hotel is easy to reach by car.

Call for toll free reservations (800) 327-1128

## Holiday Inn Main Gate East



**Holiday Inn**

5711 W. Irlo Bronson Memorial Highway  
(West U.S. Highway 192)  
Kissimmee, FL 34746  
Phone: (407) 396-4222 Fax: (407) 594-5276  
[www.holidayinnmge.com](http://www.holidayinnmge.com)

### Relax. It's Holiday Inn – Guest Room Accommodations

Your Holiday Inn Main Gate East guest room accommodations are **newly renovated** with vibrant colors to stimulate the senses. Your guest room accommodations include a coffee / tea maker with a daily supply of coffee and tea, in-room safe large enough for a laptop, and a 32 inch flat panel television. Every guest room has voice mail service so you don't miss any important calls as well as wake up services. For your added convenience each room has an iron / ironing board and hair dryer. Upgraded room types are available for an additional charge. Try the king bed room with an added work desk and couch / sitting area. The Kids Suites are a favorite with families traveling with kids.



### Amenities Overview

#### 444 Brand New Interior Corridor Rooms

##### All Rooms Include:

- Coffee Maker
- Hair Dryer
- Iron/Board
- Safe
- Free Disney Channel
- Voice Mail/Data Ports
- Wireless High-speed Internet Access

##### Facilities Include:

- Oversized Heated Pool, Kid's Pool and Jacuzzi
- Business Center and ATM Machine
- Guest Service Desk
- Over 4,000 sq. ft. of flexible meeting space
- Kid's Theater and Interactive Video Arcade
- Children's Playground
- Trattoria Food Court and Chianti Lounge
- Customized Parties
- Gift Shop
- Coin Laundry
- Wireless Internet
- Fitness Center
- Free Scheduled Transportation to **Walt Disney World® Theme Parks** and the **Lake Buena Vista Factory Outlet Stores**.



Just 2.5 miles from the *Walt Disney World®* Resort entrance

Call for toll free reservations (800) 327-1128

## Holiday Inn Main Gate East



# Holiday Inn

5711 W. Irlo Bronson Memorial Highway  
(West U.S. Highway 192)  
Kissimmee, FL 34746  
Phone: (407) 396-4222 Fax: (407) 594-5276  
[www.holidayinnmge.com](http://www.holidayinnmge.com)

### Your Next Group Event

The Holiday Inn Main Gate East has **over 4000 square feet of meeting space**. We can assist you in planning the most intimate cocktail party to the most extravagant wedding reception and everything in between. Our professional sales and catering staff will assist you with all the details so you can enjoy your event. Our staff can cater your events from Bar Mitzvah's and holiday parties to Quinceaneros and receptions.

### Your Business Meeting



Turn your next business function into a successful event at the Holiday Inn Main Gate East. Our flexible meeting space can accommodate up to 250 people. At the Holiday Inn Main Gate East we also have a comfortable and convenient pre function area which is a perfect location for your group's registration. Leave the details of your next business function to our professional conference planners who will provide you with the personalized service you deserve to ensure your meeting is a successful event. For your added convenience, our complete business center is located adjacent to the ballroom.

### Your Wedding or Celebration Party

Whether you are planning a small, medium or large wedding, your daughter's sweet 16 birthday party, Quinceanero, or your son's Bar Mitzvah, our professional and caring staff will guide you through every step of this exciting life moment. Make an appointment today to come in and see our charmingly designed ballrooms, bridal suite and ceremony spaces. Ask about our wedding packages.



### Catering your Event



Here at the Holiday Inn Main Gate East we have a full compliment of catering menus available for you to choose from. From a simple affair to the most extravagant event we can customize it to your desires.

Call for toll free reservations (800) 327-1128

## Holiday Inn Main Gate East



# Holiday Inn

5711 W. Irlo Bronson Memorial Highway  
 (West U.S. Highway 192)  
 Kissimmee, FL 34746  
 Phone: (407) 396-4222 Fax: (407) 594-5276  
[www.holidayinnmge.com](http://www.holidayinnmge.com)

### Event Facility Layout

Event Rooms	Square Footage	Class Room Style	Theater Style	Rounds
<b>Corsica and Crete combined</b>	<b>2077</b>	<b>150</b>	<b>250</b>	<b>150-160</b> without dance floor
<b>Corsica</b>	<b>930</b>	<b>50</b>	<b>100</b>	<b>50</b>
<b>Crete</b>	<b>1147</b>	<b>100</b>	<b>150</b>	<b>90</b>
<b>Sicily</b>	<b>1666</b>	<b>90</b>	<b>150</b>	<b>100</b>
<b>Malta Boardroom</b>	<b>350</b>	<b>15</b>	<b>30</b>	<b>20</b>
<b>Cyprus Ballroom (All rooms combined)</b>	<b>3743</b>	<b>225</b>	<b>300</b>	<b>250-260</b> without dance floor
<b>Trattoria Café</b>	<b>130 seating capacity</b>			

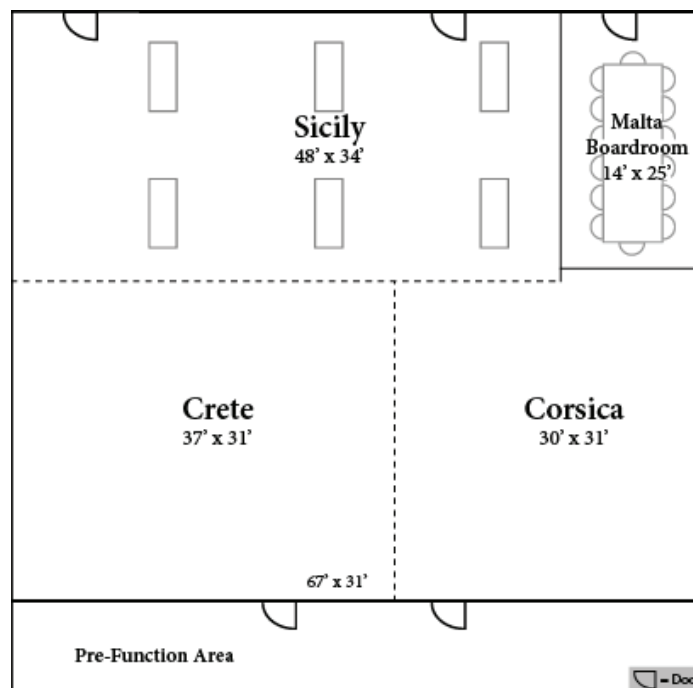

## Holiday Inn Main Gate East



Call for toll free reservations (800) 327-1128



**Holiday Inn**

5711 W. Irlo Bronson Memorial Highway  
(West U.S. Highway 192)  
Kissimmee, FL 34746  
Phone: (407) 396-4222 Fax: (407) 594-5276  
[www.holidayinnmge.com](http://www.holidayinnmge.com)

### Area Attractions Guide

*Magic Kingdom® Park* is one of 4 Theme Parks in **Walt Disney World®** Resort and captures the enchantment of fairy tales with exciting entertainment, classic attractions, backstage tours and beloved Disney Characters. Attractions at *Magic Kingdom® Park* consist of classic experiences that pay tribute to Walt Disney's concepts and designs. Celebrate adventure, fantasy, the past, the future and the imagination. This theme park is on 107 acres and meanders through 7 whimsical lands. Travel through these lands and see how fantasy becomes reality when you learn how to be a pirate, match wits with funny monsters and conquer mountains. Entertainment at *Magic Kingdom® Park* includes parades, musical stage shows, spectacular nighttime fireworks performances and the chance to meet princes, princesses, heroes and popular Disney Characters.

---

*Epcot®*, one of 4 Theme Parks at **Walt Disney World®** Resort, sprawls across 300 acres and is divided into Future World and World Showcase. Future World is full of sensational attractions as well as inspiring entertainment and shows, all of which focus on technological advancements, innovation and wonder. In Future World, ideas become reality. World Showcase is a collection of Pavilions that wrap around the World Showcase Lagoon. Inside the Pavilions, find shops, attractions and restaurants that represent the culture and cuisine of 11 countries.

---

*Disney's Animal Kingdom® Park* is full of attractions, adventures and entertainment that reflect Walt Disney's dedication to nature and conservation, and in doing so, the Park leads the way in animal care, education and research. Home to more than 1,700 animals from 250 species and sprawling across 500 acres of lush landscape, *Disney's Animal Kingdom® Park* is the largest animal-themed park in the world! *Disney's Animal Kingdom® Park* is divided into 7 areas. Within each area, encounter real and fantastic animals. Get close enough to pet some of them.

---

*Disney's Hollywood Studios™* theme park, one of 4 Theme Parks in **Walt Disney World®** Resort, offers behind-the-scenes glimpses of Hollywood-style action with live shows, thrilling attractions, backstage tours and special events that only happen in this Disney Park dedicated to entertainment. The glitz and glamour of the Hollywood Heydays from the 1930s and 1940s are captured by the neon, chrome, art deco and modern architecture throughout *Disney's Hollywood Studios™* theme park. The streets and sections of the 4 areas of the Park blend together like a large, bustling movie set.

As to Disney artwork, logos & properties: Copyright ©Disney

Call for toll free reservations (800) 327-1128

## Holiday Inn Main Gate East



# Holiday Inn

5711 W. Irlo Bronson Memorial Highway  
(West U.S. Highway 192)  
Kissimmee, FL 34746  
Phone: (407) 396-4222 Fax: (407) 594-5276  
[www.holidayinnmge.com](http://www.holidayinnmge.com)

### Area Attractions Guide



Disney's Blizzard Beach Water Park is one of 2 Water Parks in Walt Disney World Resort. Imagine plunging down one of the world's tallest, fastest free-fall speed slides - at a dizzying 55 mph - in a snowy winter playground smack in the middle of sunny Florida. Sound like a cool idea? It's only one of 22 water slides and bobsled runs at Disney's Blizzard Beach Water Park, the largest of the Walt Disney World® Water Parks. Attractions at Disney's Blizzard Beach Water Park consists of raft rides, toboggan slides, a one-acre wave pool, the Tike's Peak children's play area and intense waterslides.

Disney's Typhoon Lagoon Water Park features attractions for the whole family—from fast waterslides to a children's area with pint-sized raft rides. Catch 6-foot waves in the Surf Pool and snorkel Shark Reef— where you can snorkel with real sharks and schools of colorful fish. Attractions at Disney's Typhoon Lagoon Water Park consists of 9 waterslides—one with near-vertical drops. Twisting tides, roaring rapids, wonderful waterways and relaxing rivers are waiting at Disney's Typhoon Lagoon Water Park.



Disney's Osprey Ridge Golf Course at Walt Disney World Resort features dramatic golf holes that cut through stands of live oak, pine, palmetto, cypress and bay trees. Recognized as a Certified Audubon Cooperative Wildlife Sanctuary, the surrounding vegetation and wetlands serve as a breathtaking backdrop for a championship course. This sweeping 18-hole course is arguably one of the most tranquil locales in all of Walt Disney World Resort. It boasts 7,101 yards from the longest tees for a par of 72—making Disney's Osprey Ridge suitable for serious and recreational golfers who seek a challenge. Beauty meets technology at Disney's Osprey Ridge with the integration of the latest GPS technology into golf carts. This state-of-the-art enhancement offers realistic images of course fairways, greens and hazards that add to the golf experience.

The beautifully manicured links of Disney's Magnolia Golf Course are named for the abundance of fragrant blossoming magnolia trees that make this course truly magnificent. The course design masterfully uses the area's natural features to enhance the beauty of the lush, rolling greens and sparkling water hazards—all for a course deserving of its excellent 4 star-rating by Golf Digest. Disney's Magnolia Golf Course features wide fairways dotted with 97 bunkers. It represents a paradise for serious golfers, as well as a thrilling challenge for players at all levels.

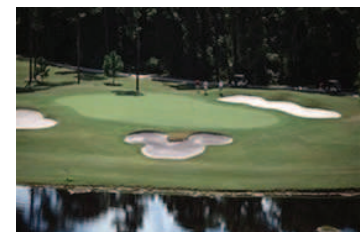

Call for toll free reservations (800) 327-1128

## Holiday Inn Main Gate East



**Holiday Inn**

5711 W. Irlo Bronson Memorial Highway  
(West U.S. Highway 192)  
Kissimmee, FL 34746  
Phone: (407) 396-4222 Fax: (407) 594-5276  
[www.holidayinnmge.com](http://www.holidayinnmge.com)

### Area Attractions Guide

**SeaWorld®** Orlando Theme Park takes you on a one-of-a-kind journey to the wonders that exist beyond the oceans door. At the heart of every being lies a spirit of wonder. The captivating and visually stunning Shamu show will transport your heart to the edge of wonder. Enjoy acrobatic dolphins, soaring birds, and amazing stunts in a show about where the sea meets the sky. For the more adventurous try the rides at Sea World Orlando. From Journey to Atlantis. Kraken, Wild Arctic and the newest addition of Manta, they are sure to get the adrenaline flowing.

---

**Aquatica®** Water Park, a whimsical, one-of-a-kind water park is unlike any you've ever experienced. One only **SeaWorld®** could create. Float through an undersea world of exotic fish, thunder through rolling rapids, relax on our white sand beaches, or take a tube slide through an underwater world where black-and-white Commerson's Dolphins play and race alongside you.

---

Go behind the scenes, beyond the screen, and jump right into the action of your favorite movies at **Universal Studios®**, the number one movie and TV based theme park in the world. It's everybody's fantasy... to leap through the screen and find yourself in the middle of your favorite motion pictures. Here at Universal Studios®, YOU become the star of some of the greatest movies and TV shows ever made. At this real, working film and TV production facility you'll find an amazing array of rides, shows, movie sets and attractions that put you right in the picture.

---

Take an unforgettable journey through **Universal's Islands of Adventure®** as the world's most cutting edge rides, shows and interactive attractions bring your favorite stories, myths, cartoons, comic books and children's tales to life. Around every bend is another epic adventure. Around every corner awaits another once-in-a-lifetime thrill. Join the battle of good versus evil above the streets of **Marvel Super Hero Island®**. Get splash happy with your favorite cartoon characters in the water rides of **Toon Lagoon®**. Come face to face with the dinosaurs of **Jurassic Park®**. Venture through the mists of time as you experience the epic adventures of **The Lost Continent®**. And step right into the pages of the children's books of Dr. Seuss in **Seuss Landing™**.

## Holiday Inn Main Gate East



Call for toll free reservations (800) 327-1128



# Holiday Inn

5711 W. Irlo Bronson Memorial Highway  
(West U.S. Highway 192)  
Kissimmee, FL 34746  
Phone: (407) 396-4222 Fax: (407) 594-5276  
[www.holidayinnmge.com](http://www.holidayinnmge.com)

### Directions to the Holiday Inn Main Gate East

From the Orlando International Airport, follow south airport exit. Turn right onto SR-417 South (Greenway) to Celebration exit, U.S. Hwy. 192 East. Hotel is 1/4 mile east on left.

---

From Orlando International Airport, take north exit to 528. Take 528 West (Beachline Expressway) to I-4 West. Take I-4 to Exit 64, (Hwy 192). Take 192 East. Hotel is 1 mile on the left across from Old Town Amusement Park.

---

From Walt Disney World® Resort, take US Hwy 192 East. Hotel is 2 miles on left between Guide Markers 9 and 10.

---

From I-4 West, take Exit 64, US Hwy 192 East. Hotel is 1 1/2 miles on left between Guide Markers 9 and 10.

